



GENUINE PARTS

INSTALLATION INSTRUCTIONS

DESCRIPTION: Rear View Mirror Appliqué
APPLICATION: Nissan Versa Note (Hatch Back)
PART NUMBER: 999G3 44200 / 01 / 02 / 03 / 04 / 05

KIT CONTENTS:

Item	Qty.	Description
A	1	Mirror Applique
B	1	Alcohol wipe
C	1	Instruction Replacement Template

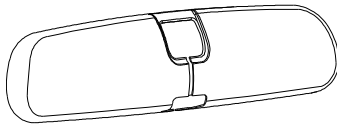

A



B



C

TOOLS REQUIRED:

- None.

PRE-INSTALLATION WARNINGS, CAUTIONS, CRITICAL STEPS, and NOTES:

- Read the installation sheet and check the entire kit for possible damage or defects before performing any work.
- Always dry fit parts before removing the adhesive liners to ensure proper fit, alignment, and component location. Kit contents are labeled to indicate proper location.
- Part application only for OE mirror.

CAUTION

- Do not touch the tape side with your fingers to avoid contaminating the tape and reducing adhesion strength.
- These parts are to be installed when the ambient temperature is between 60°F - 80°F, (16°C - 26 °C).
- Do not wash or expose the vehicle to a wet environment for 24 hours after installing the Appliqué.
- The tape will set in 15-20 seconds after the installation.
- Do not reposition the appliqués once the tape has started to set/adhere to vehicle.

INSTALLATION PROCEDURE:

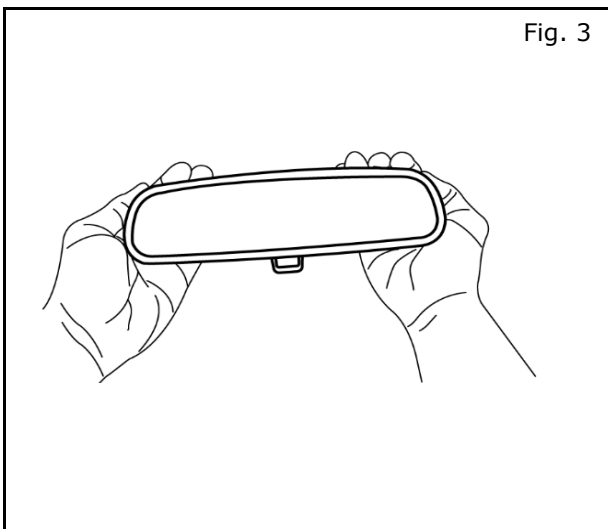
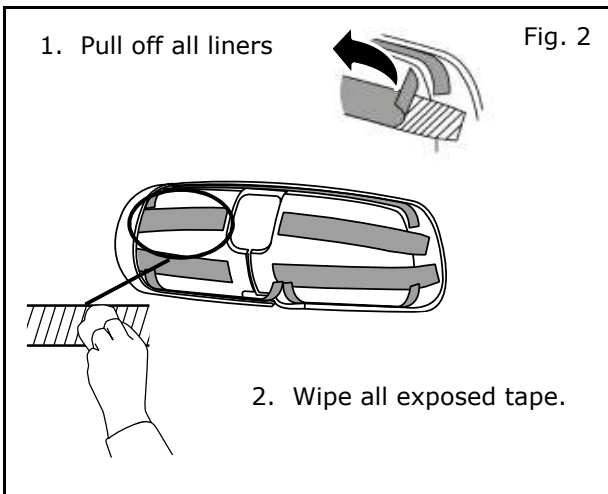
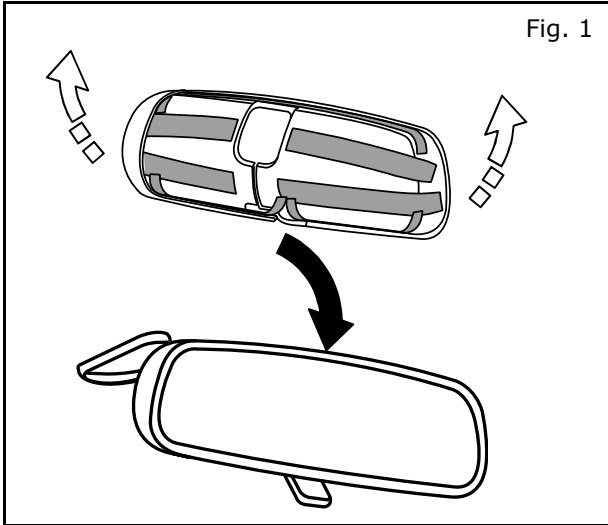

- 1) Locate the rear view mirror, and dry fit part before removing the adhesive liner to establish correct part orientation.
(Fig. 1)

Note: Part has to be gently opened up to fit over the mirror post.

- 2) Remove the applique and use an alcohol wipe to clean the back of the mirror where appliqué is to adhere.
- 3) Remove adhesive liner from back of the mirror applique.
(Fig. 2)
- 4) While using a new section of the alcohol wipe, wipe all exposed tape to assist ease of installation.
(Fig.2)
- 5) Carefully and lightly place part in position. Pull the applique back and squeeze entire surface with 15lbs force for 30sec until tape sets.
(Fig. 3)

FINAL INSPECTION:

- Confirm day-night toggle lever works properly without interference.

