



GENUINE PARTS

INSTALLATION INSTRUCTIONS

1. **DESCRIPTION:** Crossbar Accessory Kit

2. **APPLICATION:** Nissan Armada

3. **PART NUMBER:** 999R1-2V000

4. KIT CONTENTS:

ITEM NO.	QTY.	DESCRIPTION
1	2	Crossbar Assembly
2	1	Hardware Kit

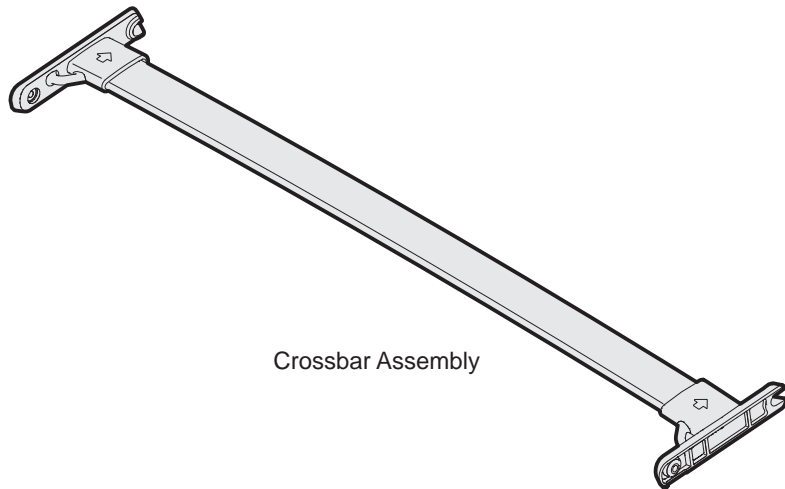

Insert



Thumbwheel (with shoulder)

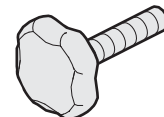

Thumbwheel (no shoulder)

5. **TOOLS REQUIRED:** T-25 Torx Driver

6. SPECIAL INSTRUCTIONS / NOTES:



WARNING

- Properly secure all cargo with ropes or straps to help prevent it from sliding or shifting. In a sudden stop or collision, unsecured cargo could cause personal injury.
- Use care when placing or removing items from the roof rack. If you can not comfortably lift the items onto the roof rack from the ground, use a ladder or stool.

INSTALLATION INSTRUCTIONS - CROSSBAR KIT

INSTALLATION PROCEDURE:

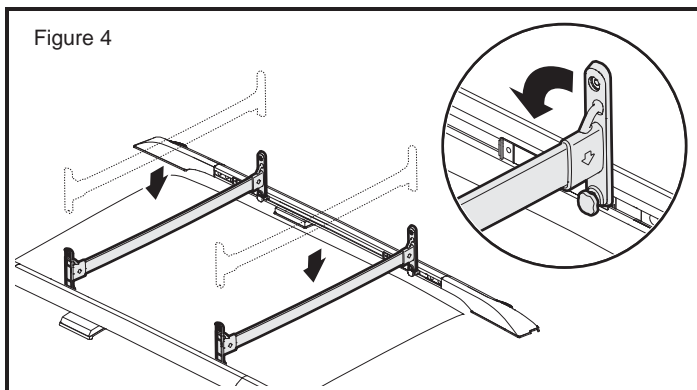
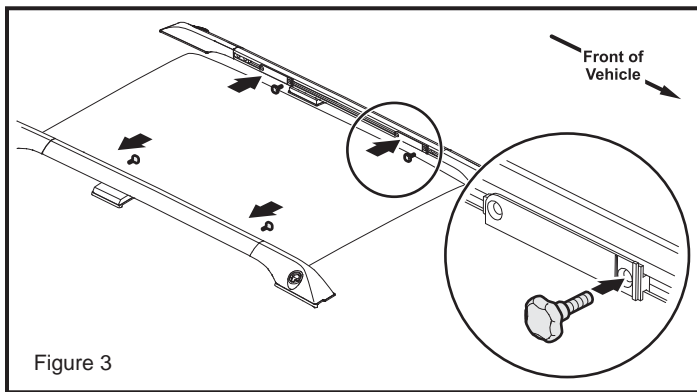
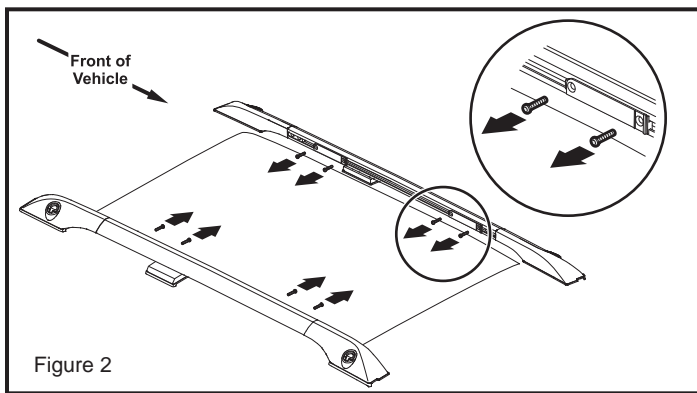
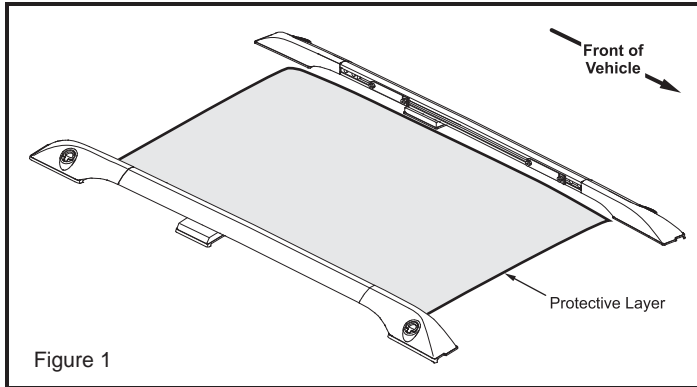

INSTRUCTIONS:

Always evenly distribute the cargo to the roof rack. The maximum total load limit is 200Lbs (75kg) evenly distributed.

- 1) Use a damp cloth to clean the area where the crossbar will be installed, as indicated by the shaded area in Figure 1.
- 2) Place a protective layer, for example a towel or sheet, on the roof to prevent scratching or damaging the vehicle while installing the crossbar kit.
- 3) Using T-25 torx driver, remove screws from H-blocks as shown in Figure 2.
- 4) Install shouldered thumbwheel in forward most position in all 4 locations. Do not tighten at this time. See Figure 3.

Install Crossbars

- 5) Position new crossbars onto thumbwheel and rotate down as shown in Figure 4.

NOTE: Front of vehicle arrows should face forward when crossbars are in position.

INSTALLATION INSTRUCTIONS - CROSSBAR KIT

INSTALLATION PROCEDURE continued:

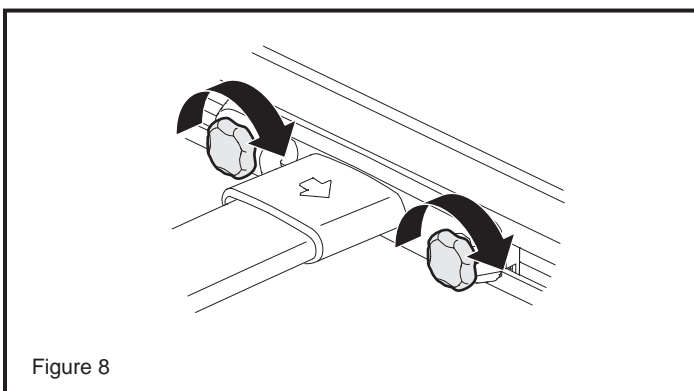
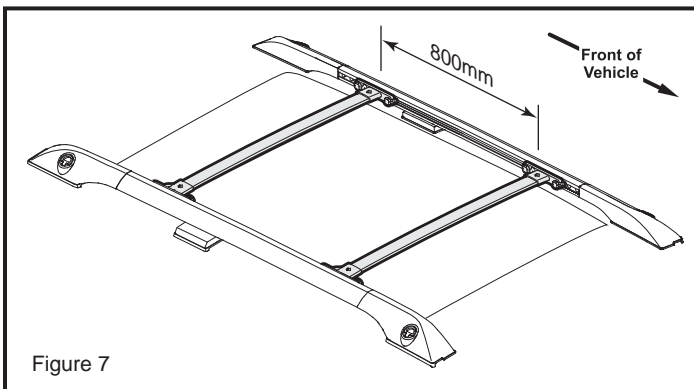
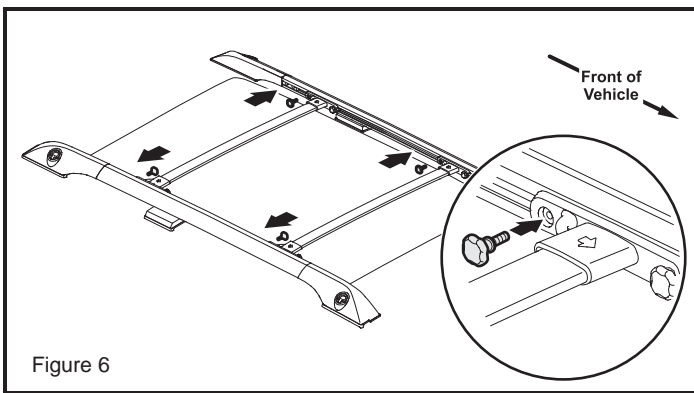
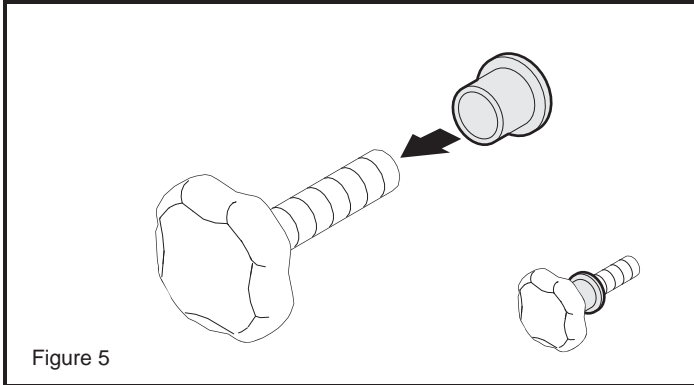

INSTRUCTIONS continued:

6) Add inserts to “non shouldered” thumbwheels as shown. See Figure 6.

7) Align hole in crossbar with hole in slider. Install second thumbwheel (thumbwheel with no shoulder). Do not tighten at this time. See Figure 6.

8) Position front crossbar in “Full Forward” position. Rear crossbar should be 800mm behind the front crossbar. See Figure 7.

NOTE: If crossbars do not slide, loosen thumbwheel by turning counter clockwise.

9) Once crossbars are in position, turn all thumbwheels clockwise to secure in position (hand tighten). See Figure 8.