



## GENUINE PARTS

### INSTALLATION INSTRUCTIONS

**1. DESCRIPTION:** Rear Bumper Step Assist

**2. APPLICATION:** Titan (2008 and Later)

**3. PART NUMBER:** 999T6 WU000-C1

**4. KIT CONTENTS:**

Item	Qty	Description	Service Part Number
A	1	Linkage Assembly	
B	1	Assembly Mount	
C	1	Bumper Bracket	
D	1	Step Pad	
E	1	Hardware Kit	
F	2	Bolt Hex 10mm x 65mm	81-B7245-2A
G	2	Washer 10mm	
H	2	Bolt Hex Flange 12mm x 45mm	
I	2	Socket Head Cap Screw 1/4-20 x 1in.	
J	2	1/4-20 Nut Plate	

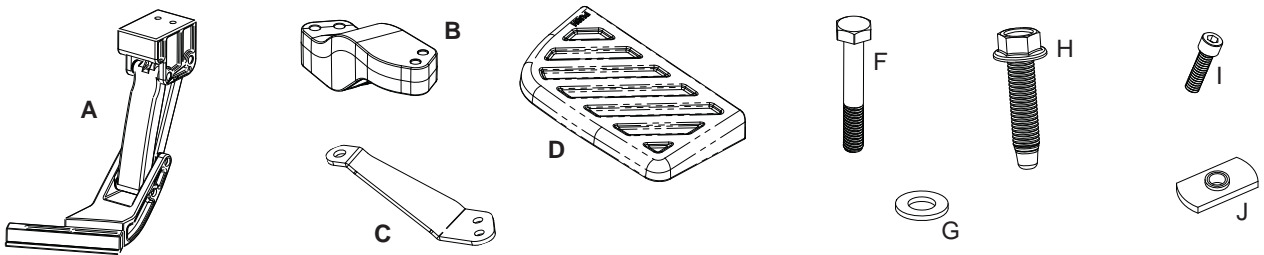

**5. TOOLS REQUIRED:**

Socket Wrench, 9" Extension, 17mm Socket, 18mm Socket, 3/16" Hex Bit Socket, Torque Wrench

**6. PRE-INSTALLATION CAUTIONS / NOTES:**

Dealer Installation Recommended.

**! CAUTION**

- Be careful of sharp edges under vehicle.
- Bolts must be tightened to specified torque values.

## REAR BUMPER STEP ASSIST

### 7. INSTALLATION PROCEDURE:

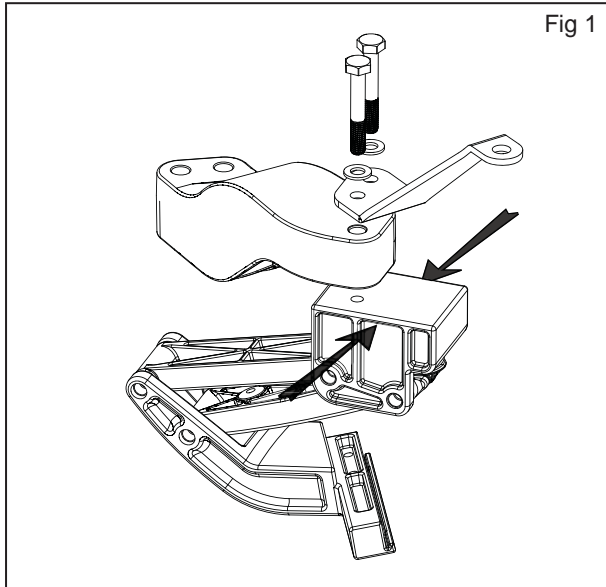

- 1) Raise and secure vehicle on lift.
- 2) Secure Linkage Assembly in vice at points indicated by the arrows in figure 1.  
NOTE: Protect (cover) part with cloth when placed in vice for paint damage.
- 3) Orient all parts as shown in figure 1 and torque (2) Hex Bolts to 33 ft-lbs (44Nm).  
NOTE: Keep step pad linkage assembly in closed or stowed position.

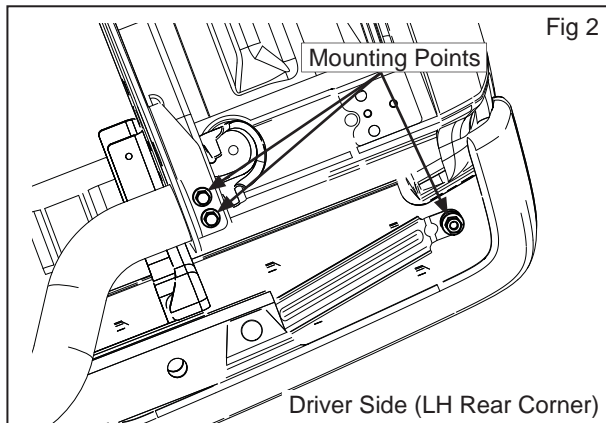

- 4) Remove (2) hitch mounting bolts as shown in figure 2.
- 5) Remove (1) bumper support bracket nut as shown in figure 2.  
NOTE: Do not apply upward pressure when removing the bumper support bracket nut. If carriage bolt slips, apply pressure directly above the carriage bolt in the downward direction to keep from spinning.
- 6) Rotate the bumper step into position, aligning the bumper bracket with the carriage bolt in the bumper.  
**NOTE: When positioning be careful not to pinch Vehicle Harness.**

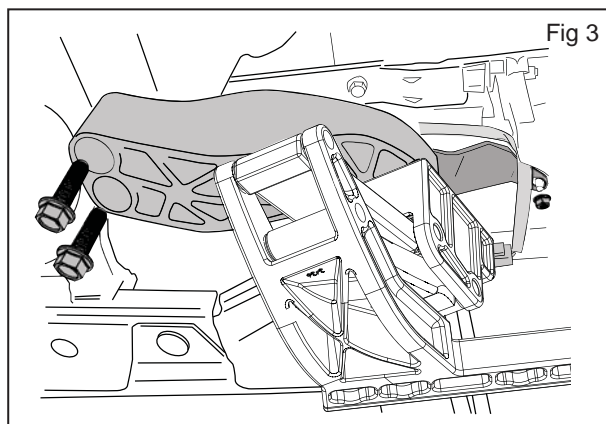

- 7) Install (2) replacement bolts into assembly mount through hitch member as shown in figure 3. Hand tighten.
- 8) Re-install (1) nut onto bumper support bracket. Hand tighten.
- 9) Torque (2) hitch mounting bolts to 101 ft-lbs (137 Nm).
- 10) Torque (1) bumper support bracket nut to 53 ft-lbs (72Nm).

## REAR BUMPER STEP ASSIST

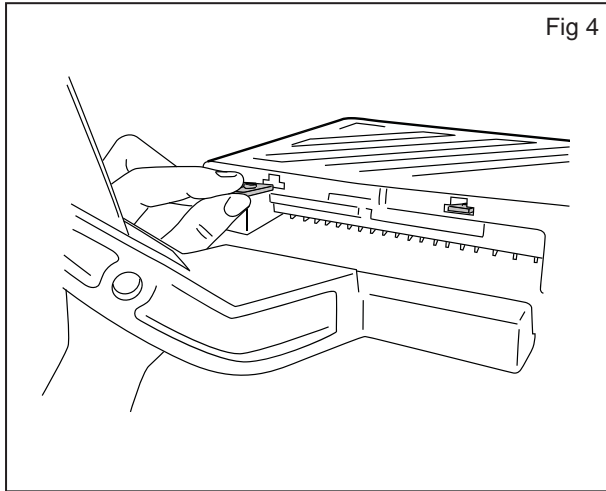

- 11) Mount Step Pad to Linkage Assembly as shown in figure 4.
  - a) Push Linkage Assembly into lowered position.
  - b) Insert Nut Plate into Step Pad with raised lip of nut facing upward.
  - c) Locate Step Pad into lower mount of Linkage assembly.

- 12) Install cap screw into step pad and torque to 10 ft-lbs (13.5 Nm) as shown in figure 5.

- 13) Lower vehicle from lift.

