



GENUINE PARTS

INSTALLATION INSTRUCTIONS

1. DESCRIPTION: Cargo Organizer

2. APPLICATION: Nissan Titan – King Cab and Crew Cab

3. PART NUMBER: 999C2 WU001/2 – King Cab (Steel/Graphite)
999C2 WU003/4 – Crew Cab (Steel/Graphite)

4. KIT CONTENTS:

<u>Item No.</u>	<u>Qty.</u>	<u>Description</u>
1)	1	Cargo Organizer
2)	2	Brackets
3)	6	Push-pins
4)	3	Non-Slip Mats
5)	1	Installation Instructions Replacement Template

5. TOOLS REQUIRED:

There are no tools required for this installation.

6. NOTES:

To maintain the luster of your Cargo Organizer, clean with a cloth as required using standard automotive vinyl, leather and upholstery cleaners or soap and water.

When properly installed, organizer can be rotated at the seat bracket to gain access underneath the organizer for cleaning or repositioning floor mats. Do not force rotation or organizer brackets may be damaged.

INSTALLATION INSTRUCTIONS - Cargo Organizer

7. INSTALLATION PROCEDURE

1)

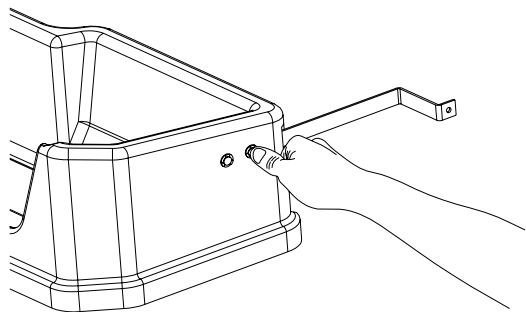

1) Preparation of Organizer

- a) Insert a bracket through the slot in the rear of the organizer. Align the two bracket holes with the two holes in the organizer. Ensure that the bracket bend faces outward, as shown.
- b) Insert a push-pin through the organizer and bracket holes. Center locking pin should be extended at this point. Push the center locking pin to engage fully to secure the bracket to the organizer.
- c) Repeat step (b) for the second organizer hole.
- d) Attach the second bracket on the opposite side of the organizer using the same procedure.

2)

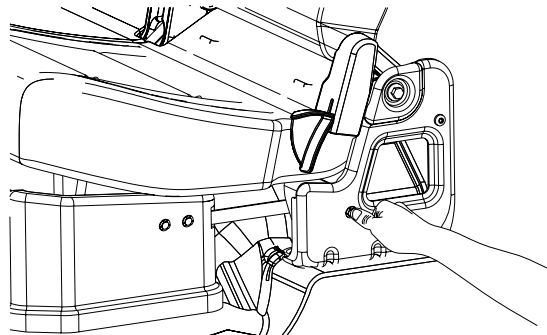

2) Install Organizer in Vehicle

- a) Open the rear doors and fold up both halves of the rear seat (see owner's manual).
- b) Place the organizer in the vehicle and adjust such that the holes in the organizer bracket align with the small holes in the side of the seat bracket.
- c) Insert a push-pin through the seat bracket and organizer bracket. Center locking pin should be extended at this point. Push the center locking pin to engage fully to secure the organizer to the seat bracket.
- d) Install each non-slip mat into its corresponding section of the organizer.

3) Removal of Organizer From Vehicle

- a) Use the tip of a thin, flat-blade screwdriver to pry up the center locking pin. Then the entire push-pin assembly can be removed. Do not try to remove the push-pin with the center locking pin engaged.