



GENUINE PARTS

INSTALLATION INSTRUCTIONS

DESCRIPTION: Splash Guard-Rear

APPLICATION: Sentra (2013)

PART NUMBER: 999J2 LZ004

KIT CONTENTS:

Item	Qty.	Part Description	Service Part Number
A	1	Splash Guard - Rear Left	N/A
B	1	Splash Guard - Rear Right	N/A
C	4	Phillips Head Screw M5 x 20mm	14-51 00891
D	4	Spring Clip	12-41 00771
E	1	Installation Instruction Replacement Template	999V2 AW000

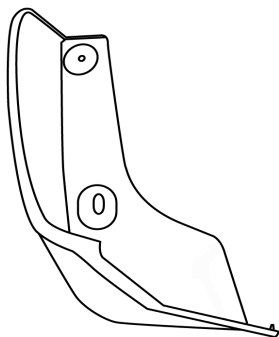

A

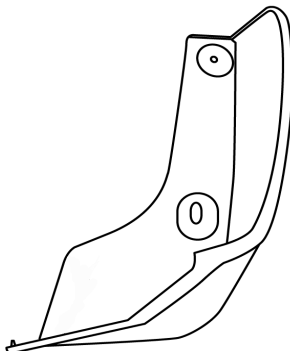

B



C



D



E

TOOLS REQUIRED:

- Drill
- #2 phillips screw driver
- awl
- 6mm (1/4") drill bit
- Flat head screw driver

PRE-INSTALLATION WARNINGS, CAUTIONS, CRITICAL STEPS, and NOTES:

- These installation instructions are for the left side of the vehicle; the same procedure applies to the right side.
- Dealer Installation Recommended.

INSTALLATION PROCEDURE:

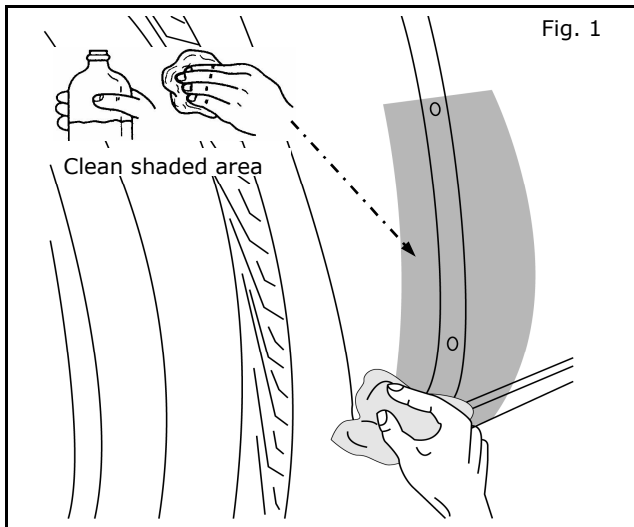

- 1) Clean installation surface (shaded area) with mild soap/water mixture.

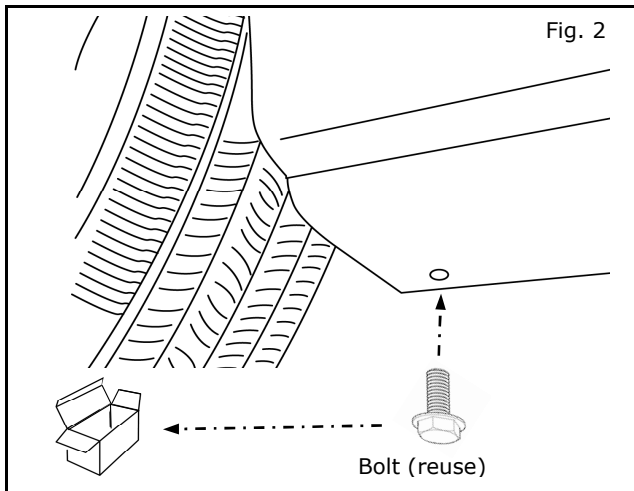

- 2) Remove bolt and save.

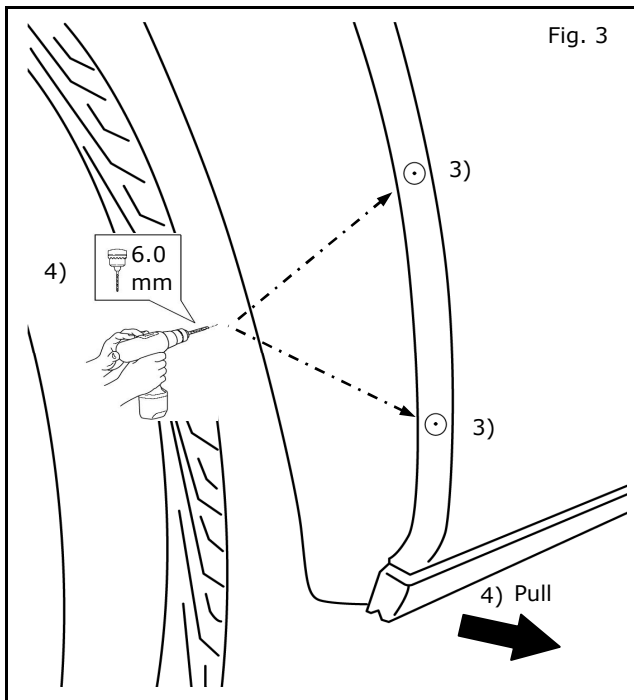

- 3) Mark center of scribe marks with awl.

NOTE: Scribe marks may be very faint. For best visibility, look directly at surface from front and at same height as scribe marks.

- 4) While pulling rear bumper outward drill 6mm (1/4") holes at center of scribe mark locations on bumper.

INSTALLATION PROCEDURE: (continue)

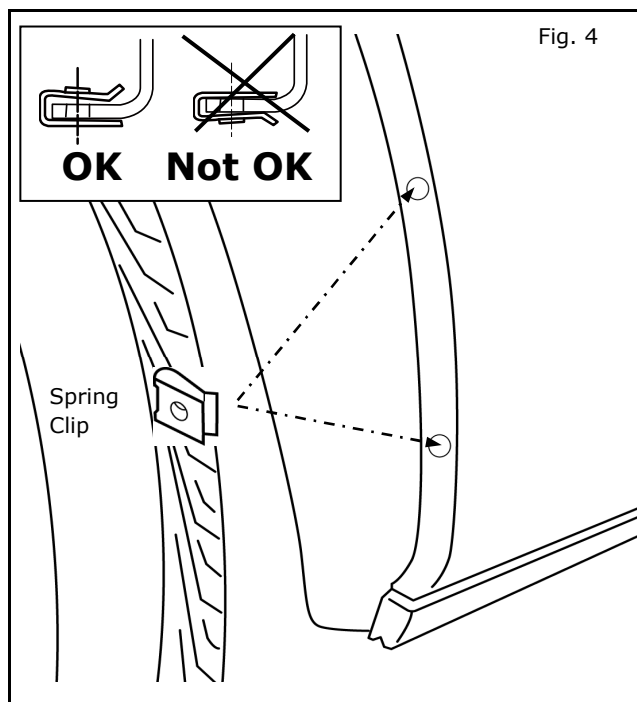

5) Install spring clip.

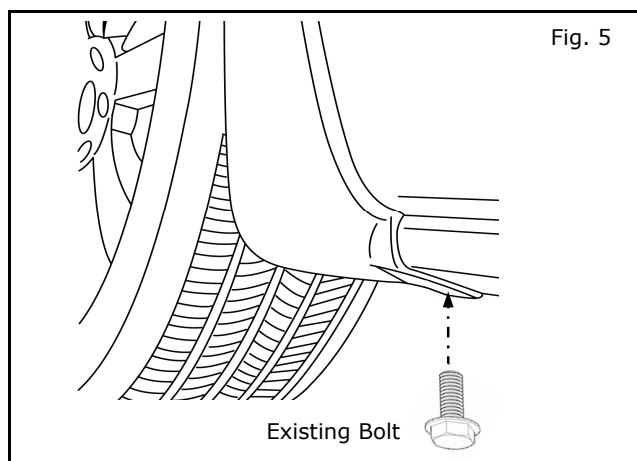

- 6) Align splash guard to vehicle.
- 7) Install bolt.

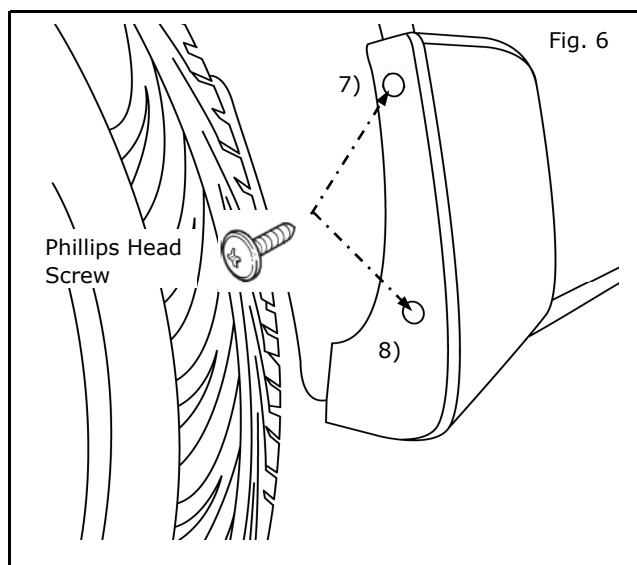

- 8) Insert and tighten top screw.
- 9) Insert and tighten bottom screw.

NOTE:
Do not over tighten screws. Reference Tighten Torque: 3.8~4.4N-m {34~39 in-lb}

10) Repeat for passenger side of vehicle.