



GENUINE PARTS

INSTALLATION INSTRUCTIONS

DESCRIPTION:	Splash Guard-Rear
APPLICATION:	Kicks
PART NUMBER:	3N3J2-5RB02

KIT CONTENTS:

Item	Qty.	Part Description	Service Part Number
A	1	Splash Guard - Rear Right	3N3J2-5RB0D
B	1	Splash Guard - Rear Left	3N3J2-5RB0C
C	2	Spring Clip	12-41 0015U
D	4	Push Pin	11296-AG000
E	2	Philips Head Screw - 20mm	14-51 00891
F	1	Installation Instruction Replacement Template	N/A

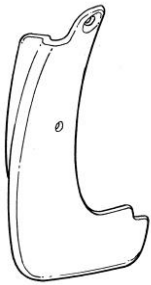

A

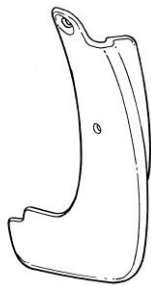

B



C



D



E



F

TOOLS REQUIRED:

- clean rag
- soap & water
- #2 phillips screw driver
- Drill
- 6mm (1/4") Drill Bit
- Awl

PRE-INSTALLATION WARNINGS, CAUTIONS, CRITICAL STEPS, and NOTES:

- These installation instructions are for the left side of the vehicle; the same procedure applies to the right side.
- Dealer Installation Recommended.
- Parts to be installed at room temperature.

INSTALLATION PROCEDURE:

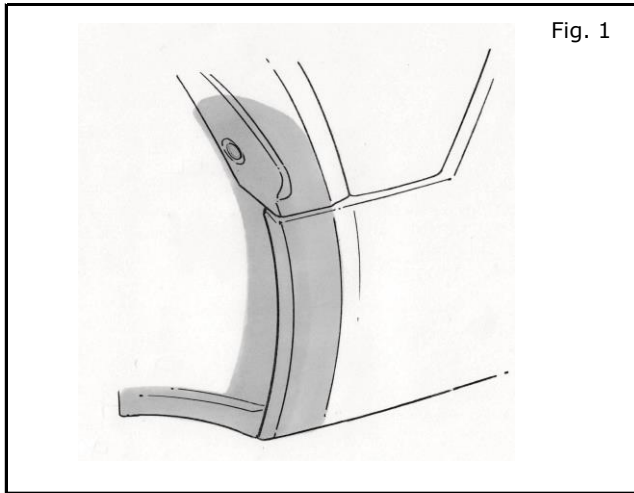

1) Clean shaded area with soap and water mixture and dry.

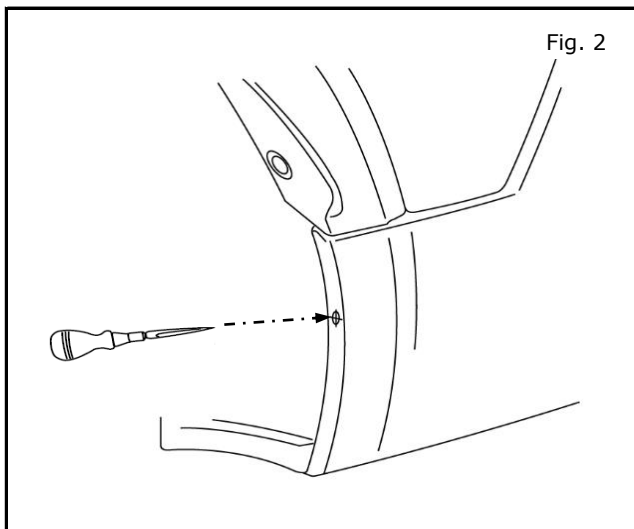

2) Mark center of scribe mark with awl.

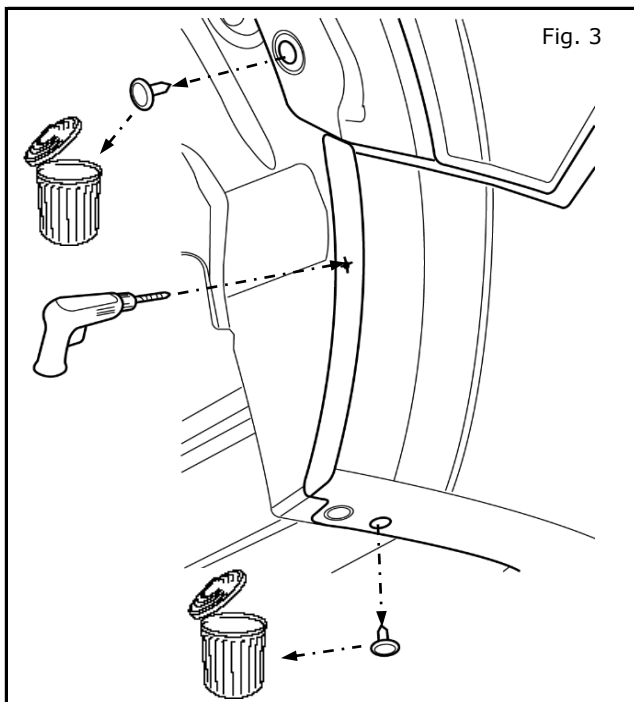

3) Drill 6mm (1/4") hole in panel and liner at center of scribed mark location.

4) Remove existing push pins and discard.

INSTALLATION PROCEDURE: (continue)

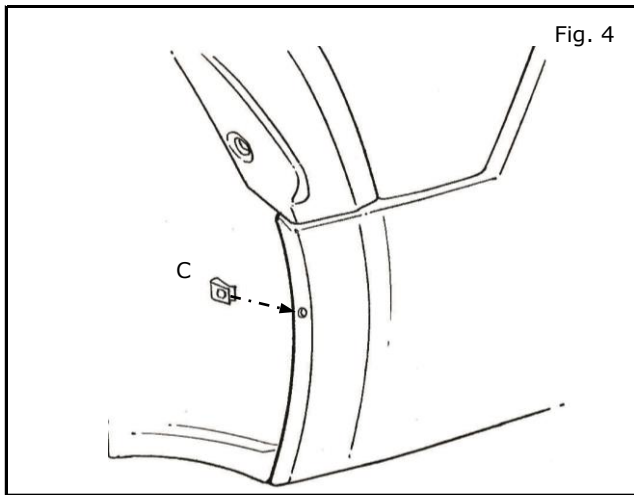

- 5) Install supplied spring clip (C) with turned up edge on inside of panel edge.

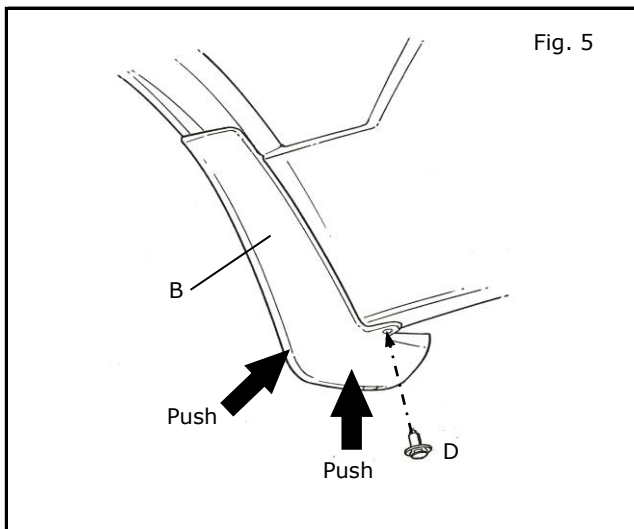

- 6) Align rear splash guard to vehicle.
- 7) While holding splash guard up and into vehicle and install supplied push pin (D).

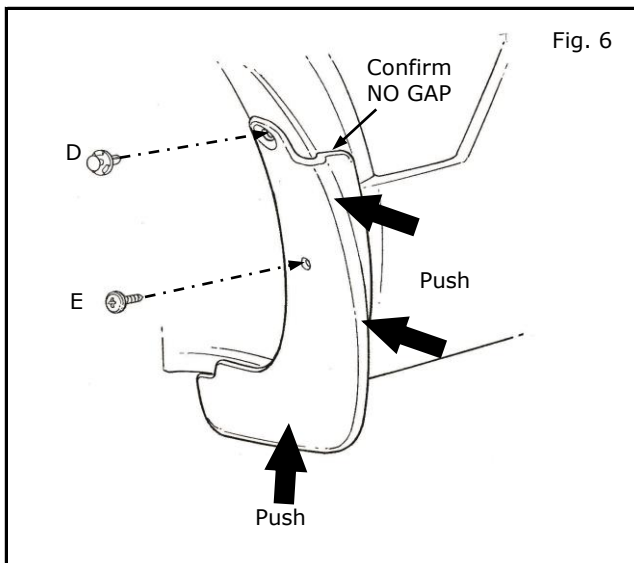

- 8) Hold splash guard up and into vehicle and install supplied screw - 20 mm (E)
- 9) Confirm no gap to vehicle. If gap exists, loosen screw, push part up and into vehicle and retighten screw to remove or reduce gap.
NOTE:
Do not over tighten screw. Reference Tighten Torque: 3.8~4.4N-m {34~39 in-lb}
- 10) Hold splash guard tight to vehicle and install supplied push pin (D)
- 11) Repeat procedure for right side.