



GENUINE PARTS

INSTALLATION INSTRUCTIONS

1. DESCRIPTION:	HITCH KIT
2. APPLICATION:	MURANO (2008) NOTE: Wire Harness Pre-wiring is not standard. Please check the Accessory Application Chart at your local dealership to determine vehicle application.
3. PART NUMBER:	999T5 CU010 NOTE: Installation of this accessory requires installation of additional Nissan Genuine Part(s): <ul style="list-style-type: none"> • WIRE HARNESS (999T8 CU000) • BALL MOUNT KIT (999T5 CU020) • CLASS II HITCH BALL (999T5 VT020)

4. KIT CONTENTS:			
Item	QTY	Description	Service Part Number
A	1	MBR ASSY-HITCH	
B	6	M6 x 1.0 x 20MM HEX FLANGE HEAD TRI-LOBE THREAD ROLLING SCREW WITH CA POINT	
C	8	M10 X 1.25 x 25MM HVY HEX BOLT WITH FLANGE	081B70252A
D	6	M12 X 1.25 x 30MM HVY HEX BOLT WITH FLANGE	081B72302A
E	1	RR PANEL LWR REPLACEMENT	
F	1	RECEIVER COVER	999T5 KN000 S2
G	1	C/C SLIP PLANE MOUNT BRACKET	
H	1	EXHAUST GASKET	20691 30P00

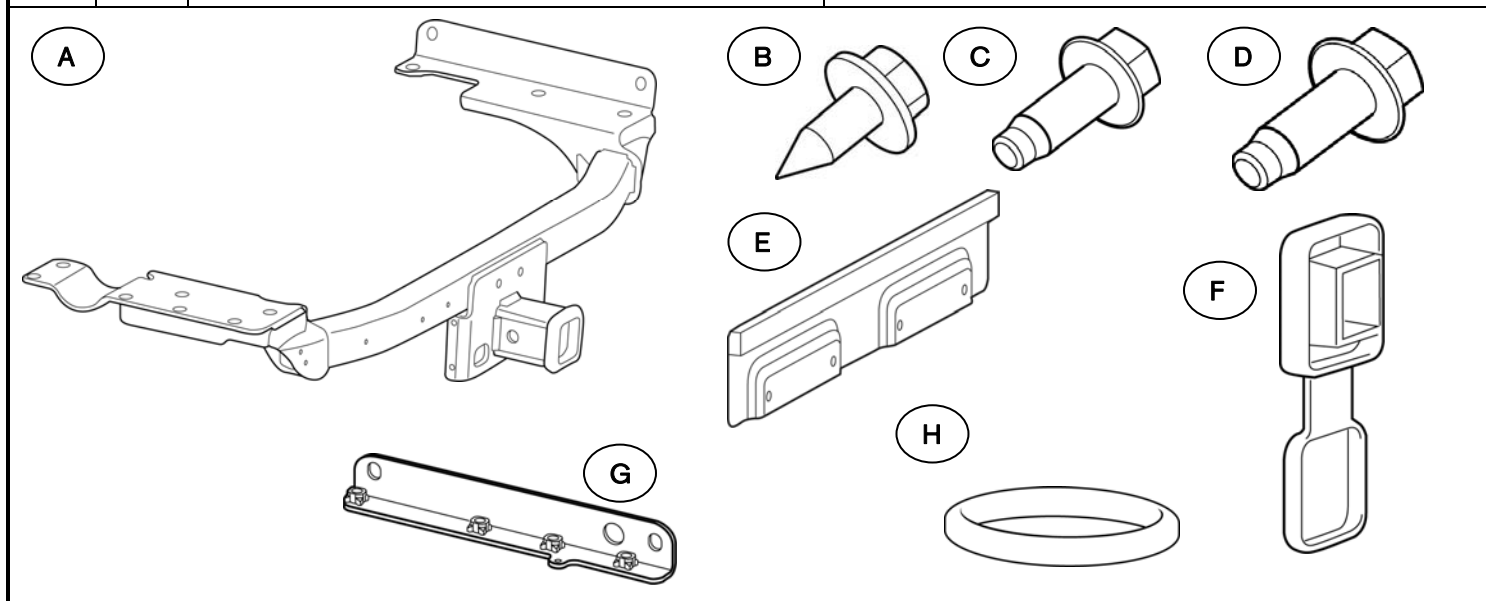

Installation Instructions – Hitch Kit

5. TOOLS REQUIRED:

Safety Glasses
Socket Wrench
10 mm Socket
14 mm Socket
16 mm Socket
17 mm Socket
9" Socket Extension
Torque Wrench



10 mm



14 mm

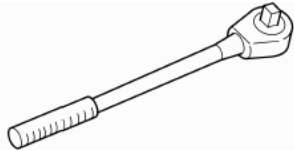

16 mm



17 mm

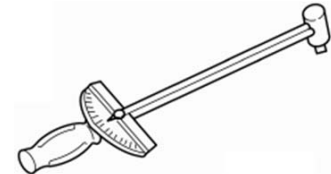

6. PRE-INSTALLATION CAUTIONS / NOTES:

Dealer Installation Recommended.

This product complies with SAE J684 V-2

HITCH CAPACITY

MAX GROSS TRAILER WEIGHT: 3,500 LBS (1590 KG)

MAX TONGUE LOAD: 350 LBS (159 KG)

CAUTION

- Vehicle towing capacity may differ from hitch rating.
- See owner's manual for vehicle towing capacity.
- Be careful of sharp edges under vehicle.
- Bolts must be tightened according to the specified torque values.

Installation Instructions – Hitch Kit

7. INSTALLATION PROCEDURE:

Fig 1

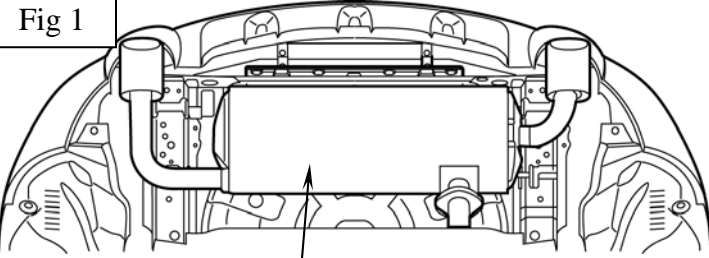

- 1) Raise and secure the vehicle on the lift.

Fig 2

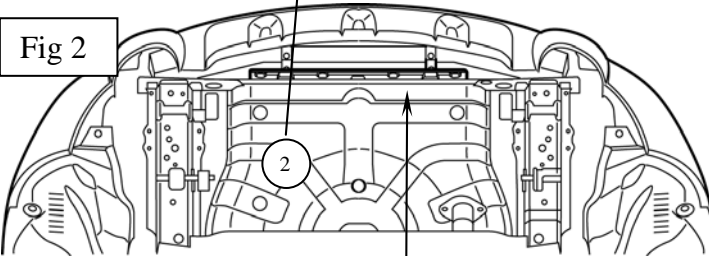

- 2) Wait until the muffler is no longer hot and remove it from the vehicle as shown in Figure 2. Discard the exhaust gasket.
- 3) Remove the exhaust hanger from the vehicle on the passenger side.
- 4) Remove and discard the marine tow hook. Be careful to avoid sharp edges on the muffler heat shield.
- 5) Remove the (2) clips attaching the rear fascia to the rear panel lower. Discard the clips.

Fig 3

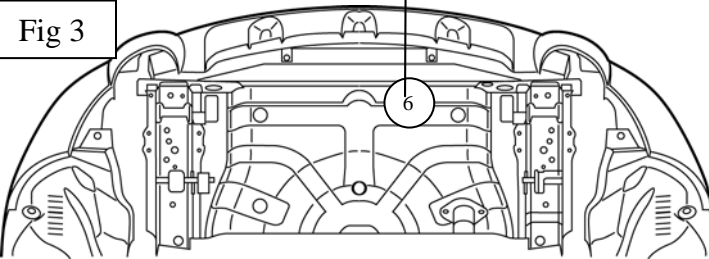

- 6) Remove the Rear Panel Lower as shown in Figure 3.
- 7) Attach trailer harness to hitch member per the harness installation instructions.

Fig 4

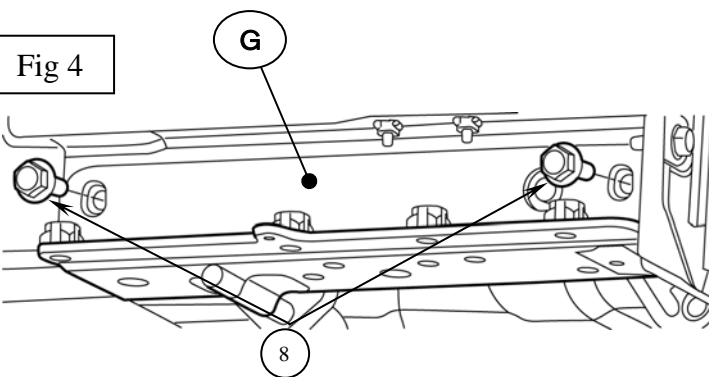

Driver's side frame rail

- 8) Loosely attach the C/C Slip Plane Mount Bracket, Item G, to the drivers side frame rail using (2) M10 bolts as shown in Figure 4.

Installation Instructions – Hitch Kit

Fig 5

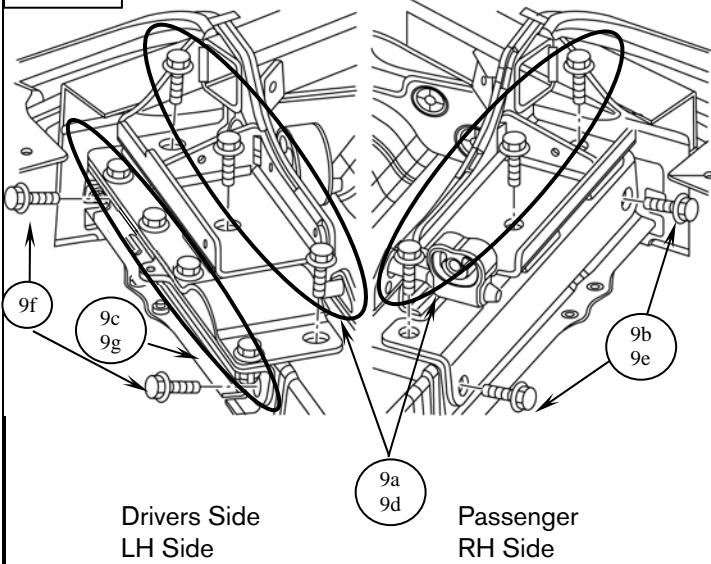

9) Attach trailer hitch to body frame rails as shown in Figure 5 using the supplied fasteners in the following order:

- a) Hand-tighten the six (6) M12 bolts in the Up-Down direction making sure to slide the hitch as far to the drivers side as possible.
- b) Hand-tighten (2) M10 bolts in the cross-car direction on the RH Mount Bracket.
- c) Hand-tighten (4) M10 bolts in the Up-Down direction between the C/C Slip Plane Mount Bracket and the Hitch

- d) Tighten (6) M12 bolts previously hand tightened to 100-130 N·m [74-96 ft·lb].
- e) Tighten two (2) M10 bolts in the cross-car direction on the RH Mount Bracket to 60-75 N·m [44-55 ft·lb].

- f) Tighten (2) M10 bolts in the cross-car direction on the C/C Slip Plane Mount Bracket to 60-75 N·m [44-55 ft·lb].

- g) Tighten (4) M10 bolts in the Up-Down direction between the C/C Slip Plane Mount Bracket and the Hitch to 60-75 N·m [44-55 ft·lb].

Fig 6

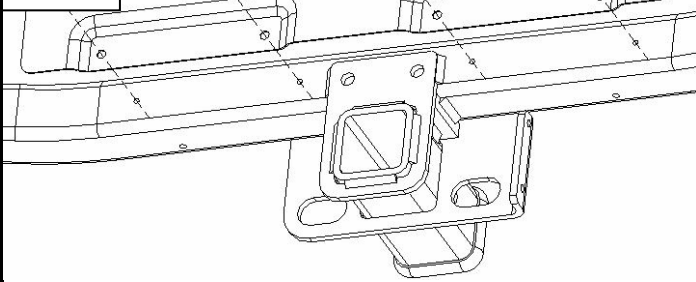

10) Attach the Rear Panel Lower Replacement using (4) M6 screws as shown in Figure 6.

Fig 7

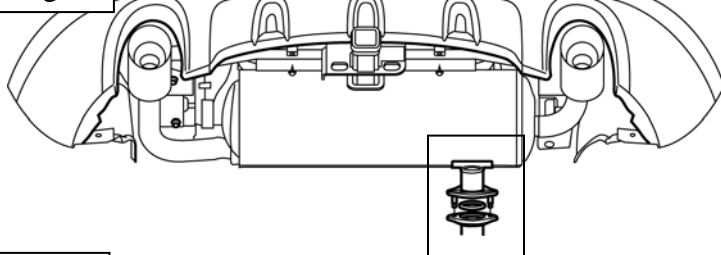

11) Complete Wire Harness installation per harness instructions.

12) Secure fascia to trailer hitch cross tube using (2) M6 screws as shown in Figure 7.

13) Reinstall the muffler using the supplied new exhaust gasket between the connection flanges as shown in Figure 8. Tighten nuts to 60-70 N·m [44-52 ft·lb].

Fig 8

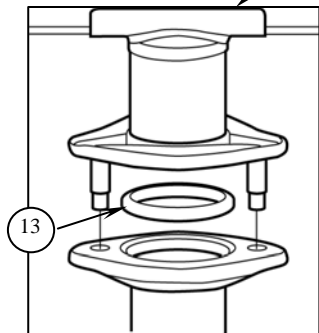

14) Install receiver cover.

15) Check hitch for proper installation.

16) Lower and remove vehicle from the lift.