



## GENUINE PARTS

### INSTALLATION INSTRUCTIONS

**DESCRIPTION:** Interior Appliqué  
**APPLICATION:** Nissan Versa Sedan  
**PART NUMBER:** 999G3 43000, 999G3 43001

#### KIT CONTENTS:

| Item | Qty. | Description                      |
|------|------|----------------------------------|
| A    | 1    | Door Switch Finisher - FR LH     |
| B    | 1    | Door Switch Finisher - FR RH     |
| C    | 1    | Door Switch Finisher - RR LH     |
| D    | 1    | Door Switch Finisher - RR RH     |
| E    | 5    | Alcohol wipe                     |
| F    | 1    | Instruction Replacement Template |

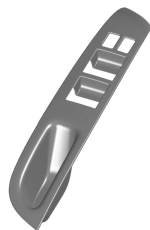

A



B



C



D



E



F

#### TOOLS REQUIRED:

- None.

#### PRE-INSTALLATION WARNINGS, CAUTIONS, CRITICAL STEPS, and NOTES:

- Read the installation sheet and check the entire kit for possible damage or defects before performing any work.
- Always dry fit parts before removing the adhesive liners to ensure proper fit, alignment, and component location. Kit contents are labeled to indicate proper location.

#### CAUTION

- Do not touch the tape side with your fingers to avoid contaminating the tape and reducing adhesion strength.
- These parts are to be installed when the ambient temperature is between 60°F - 80°F, (16°C - 26 °C).
- Do not wash or expose the vehicle to a wet environment for 24 hours after installing the Center Console Appliqué.
- The tape will set in 15-20 seconds after the installation.
- Do not reposition the appliqués once the tape has started to set/adhere to vehicle.

## INSTALLATION PROCEDURE:

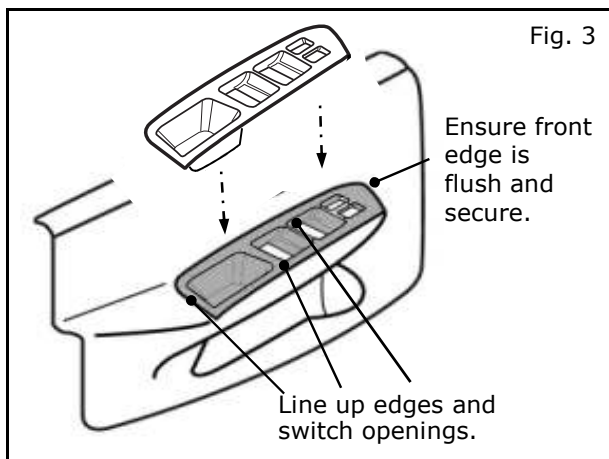
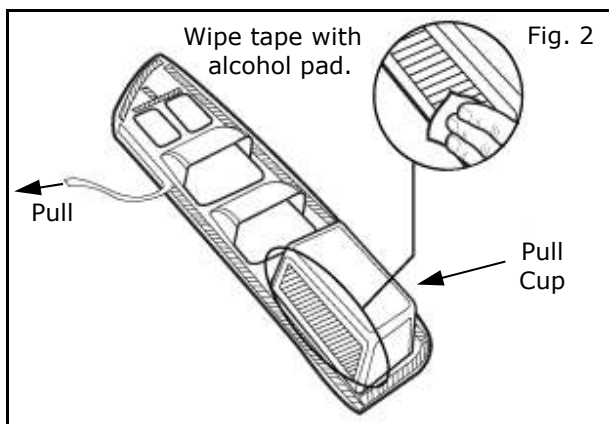
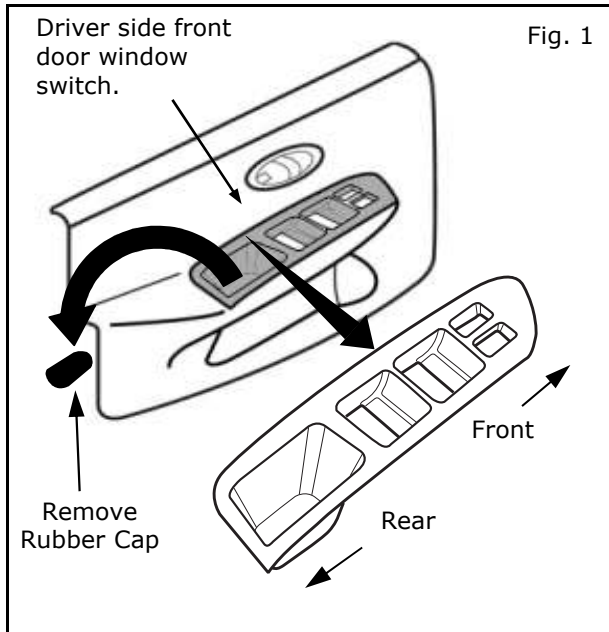

- 1) Before you start, remove and discard the rubber cap if available. Locate driver side front window switch on vehicle and door switch finisher - FR LH from the kit.  
(Fig. 1)
- 2) Dry fit part before removing the adhesive liner to establish correct part orientation.
- 3) Remove all adhesive liners from back of the door switch finisher - FR LH.  
(Fig. 2)
- 4) Use an alcohol wipe to clean the area of the vehicle where this appliqué is to adhere.
- 5) While using a new section of the alcohol wipe, wipe exposed tape on the pull cup to assist ease of installation.  
(Fig.2)
- 6) Carefully and lightly place part in position by dropping it straight down without bending or twisting. Once in place, make sure all switches operate correctly with no obstructions.  
(Fig. 3)

## INSTALLATION PROCEDURE:

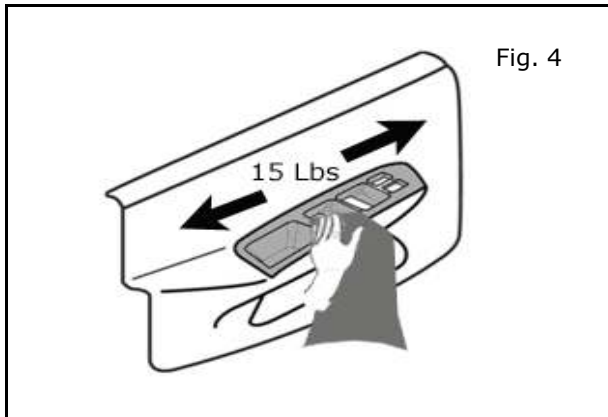

- 7) Once door switch finisher - FR LH is adjusted to the correct position, use clean towel and apply minimum 15lbs of pressure over entire surface, for at least 30 seconds.  
(Fig. 4)
- 8) Repeat steps 1 to 7 for remaining door switch finishers.

## FINAL INSPECTION:

- ☐ Verify vehicle parts are not soiled.
- ☐ Verify interior is not damaged.
- ☐ Confirm all window and door lock control mechanisms work properly.